



Castles

OFFERS IN EXCESS OF

£425,000

Montagu Crescent

London, N18 2HA

PROPERTY SUMMARY

A three bedroom Terraced property situated within 1/2 mile of Fore Street with it's shops and A406 North circular Road. The property comprises of Reception one, kitchen and bathroom to ground floor with a further three bedrooms and ladder to loft room on first floor. It also has features to include, gas central heating and double glazing, communal parking .





Montagu Crescent, London, N18

Approximate Gross Internal Area = 987 sq ft / 91.6 sq m
(Including Garage)

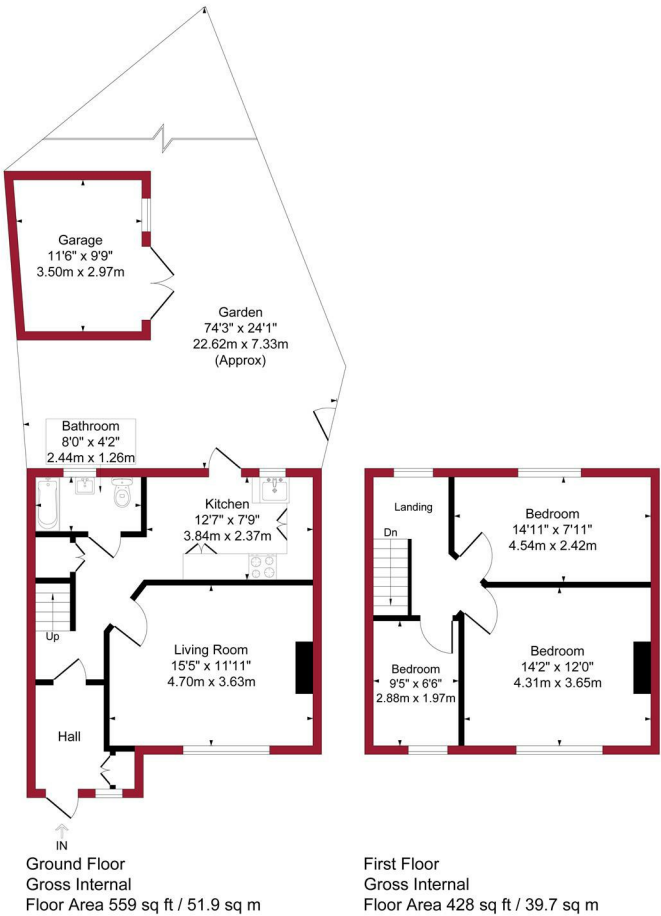

For a guide to the area
please scan this code for
more information



House
Freehold
Council:
Council Tax Band: C

Agents Note: Whilst every care has been taken to prepare these particulars, they are for guidance purposes only. All measurements are approximate and are for general guidance purposes only and whilst every care has been taken to ensure their accuracy, they should not be relied upon and potential buyers/tenants are advised to recheck the measurements



OFFICE ADDRESS
438 Hertford Road
Edmonton
London
N9 8AB

OFFICE DETAILS
020 8804 8123
edmonton@castles.london
<https://www.castles.london/>

